

Stage 1, *

Temporary flood barrier 70m (to be tie in to the existing bridges)



Ready filled sand bags (80) with polythene to be dropped off at Old Vicarage Lane.



Old Vicarage Lane to be one way traffic. More details in Traffic management plan.

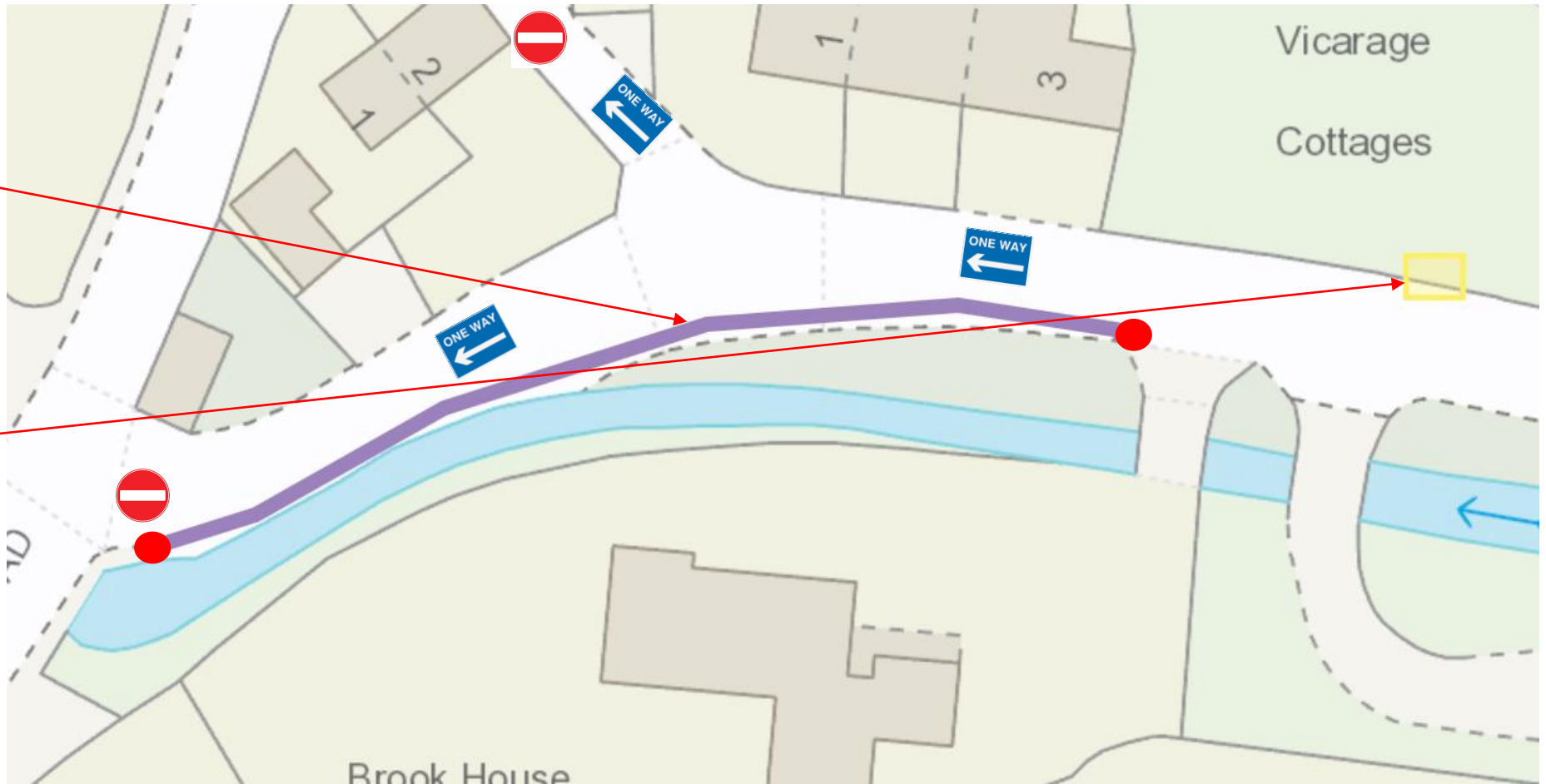

*Deployment of the barrier will be decided by duty officers and will be based on many factors.

Phase one, visualisation of the barrier would look like in the first stage



Stage 2,

Barrier to be extended by another 145m.



Drains on the dry side will be blocked to prevent overflowing.



Small 1" pump could be deployed if surface water is building up behind the barrier.

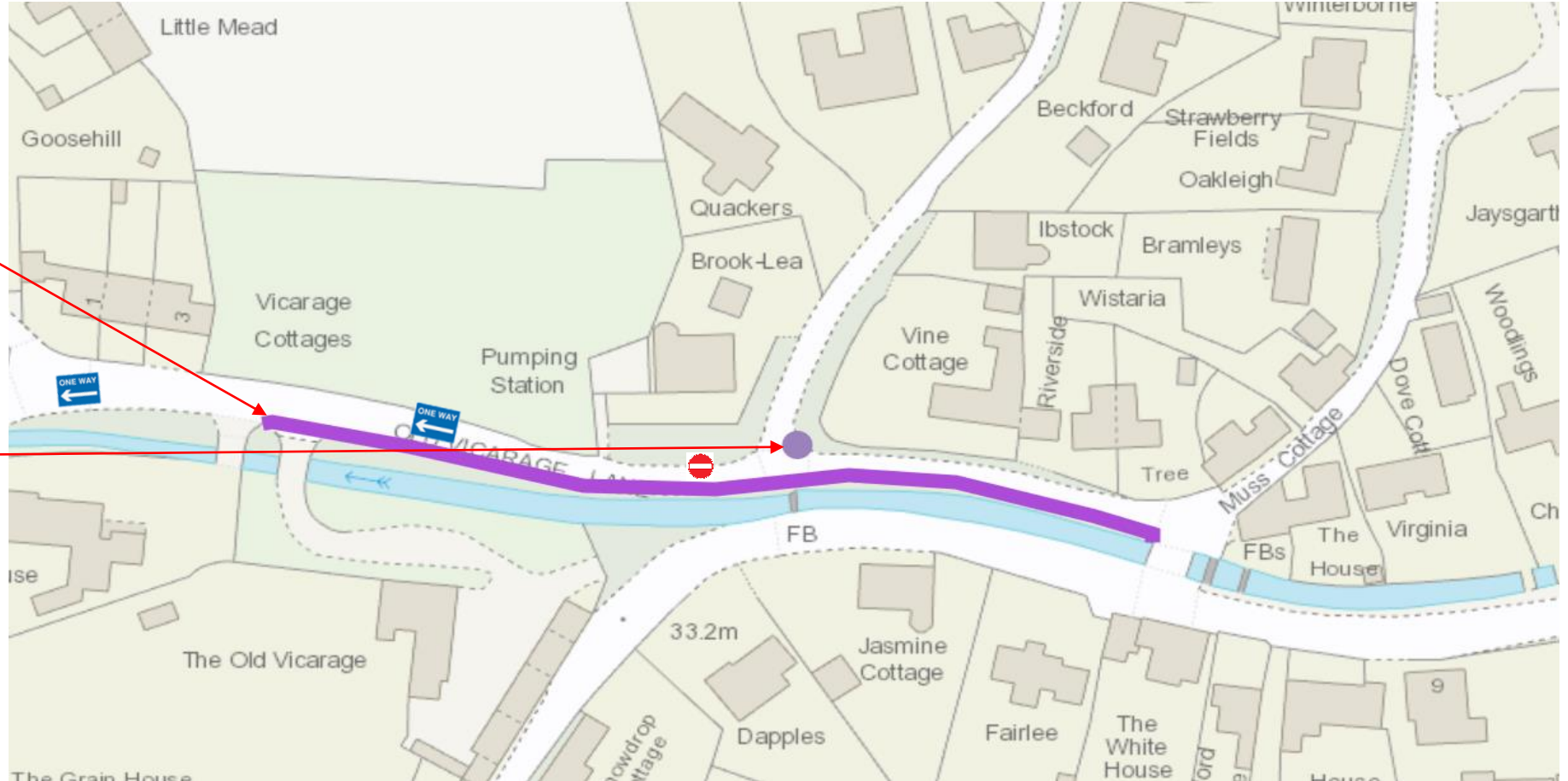

Stage 2.

Single row of sandbags with polythene to be deployed on the road to stop the wash caused by passing cars.

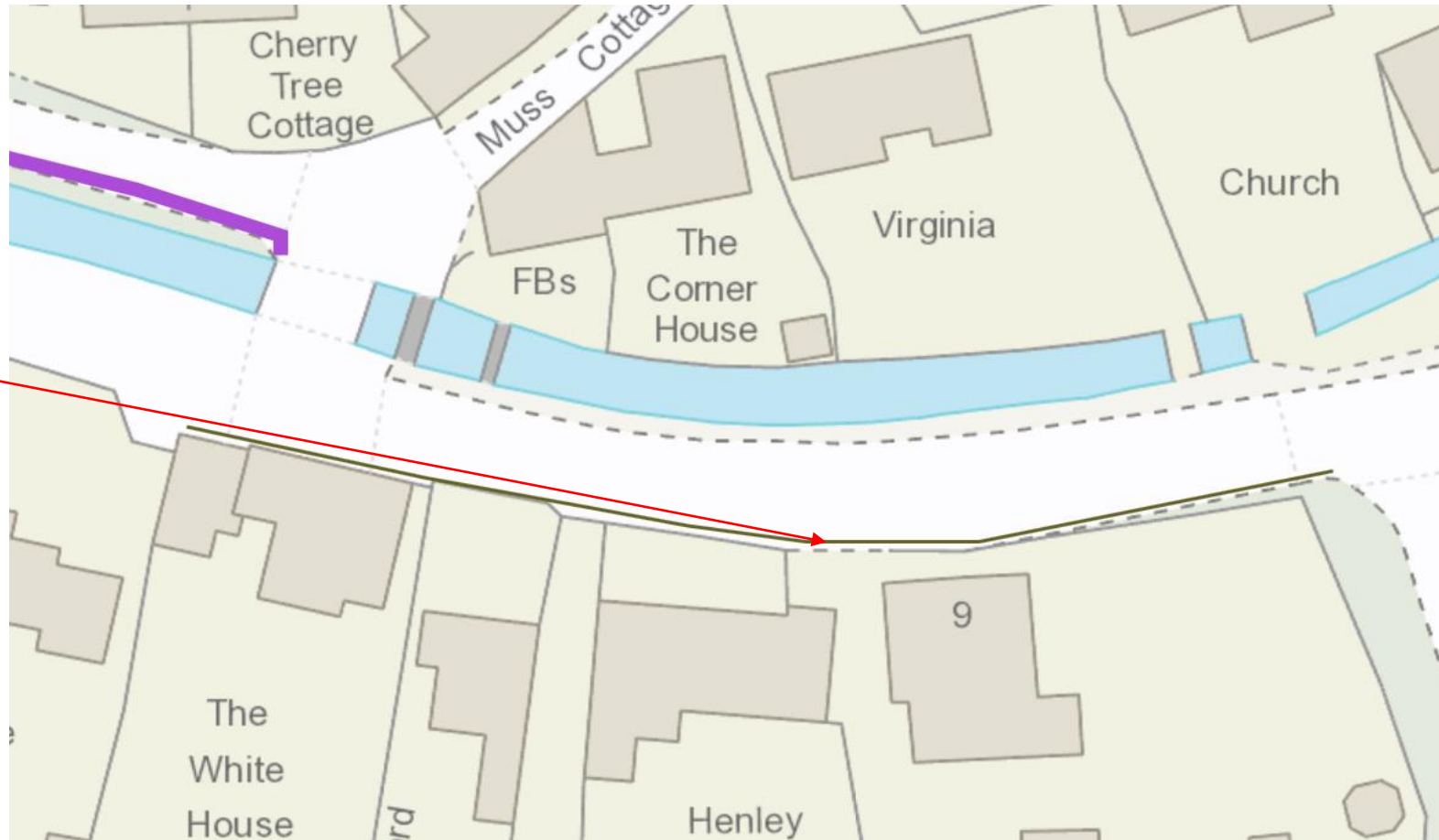

* Please refer to the TTDP for more details

Stage 2, part 2, Threshold 33.4mAOD and rising

- 2 pallets** of sand bags (60) and roll of polythene to be dropped off at the location shown.



** Please refer to sand bags guide for more details

Temporary deployment Plane Stage 1 and 2 overview

Stage 1

Stage 2

